

Delock Placă PCI Express x4 > 1 x SFF-8639 mamă U.2 NVMe internă

Descriere scurta

Această placă PCI Express de la Delock extinde PC-ul cu o interfață U.2. De exemplu, puteți conecta o unitate SSD Intel® 750 Series NVMe de 2.5".

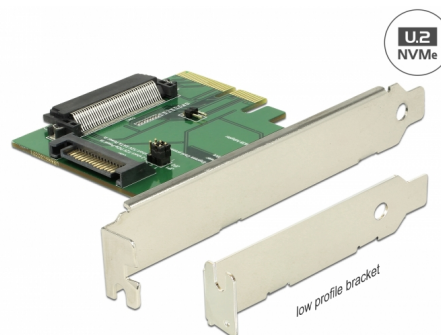

Nr. 89672

EAN: 4043619896721

Țara de origine: Taiwan,
Republic of China

Pachet: Retail Box

Detalii tehnice

- Conectori:
intern:
 - 1 x U.2 SFF-8639 mamă
 - 1 x PCI Express x4, V3.0
 - 1 x SATA, 15 pini, tată
- 2 x jumpere pentru a seta alimentarea prin interfață PCIe sau SATA
- 3 x indicator cu LED
- Acceptă NVM Express (NVMe)

Cerinte de sistem

- Windows 7/7-64/8.1/8.1-64/10/10-64, Linux ex Kernel 4.6 / Kernel 4.9.4
- PC cu slot PCI Express x4 / x8 / x16 / x32 liber

Pachetul contine

- Placă PCI Express
- Suport slot de profil redus
- 3 x șuruburi
- Manual de utilizare

Imagini

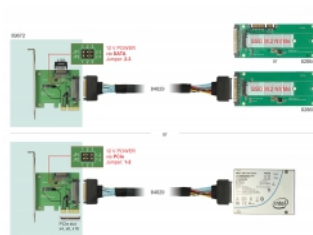
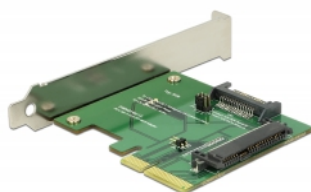

General

Function:	NVM Express (NVMe)
Specification:	U.2
Supported operating system:	Linux Kernel 4.6 sau superior Windows 10 32-bit Windows 10 64-bit Windows 7 32-Bit Windows 7 64-Bit Windows 8.1 32-Bit Windows 8.1 64-Bit ex Linux Kernel 4.9.4
Indicator cu LED:	3 x

Interface

Internal:	1 x PCI Express x4, V3.0 1 x SATA, 15 pini, tată 1 x U.2 SFF-8639 mamă
-----------	--

Technical characteristics

Jumper:	2 x
---------	-----

Physical characteristics

Slot bracket:	profil redus standard
---------------	--------------------------