

# Delock PCI Express x4 Card > 1 x internal NVMe M.2 Key M 80 mm - Low Profile Form Factor

## Description

This PCI Express card by Delock expands the PC by one M.2 slot. One M.2 module in 2280, 2260 or 2242 format can be connected.

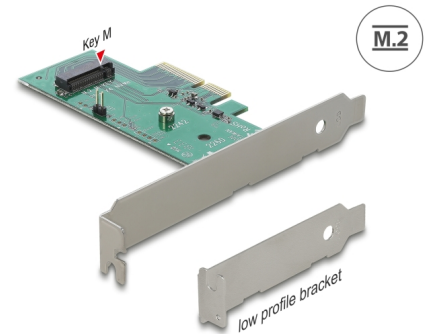

**Item no. 89370**

EAN: 4043619893706

Country of origin: Taiwan,  
Republic of China

Package: Retail Box

## Technical details

- Connectors:  
internal:  
1 x 67 pin M.2 key M slot  
1 x PCI Express x4, V4.0  
1 x 2 pin pin header for LED
- Interface: PCIe
- Supports M.2 modules in format 2280, 2260 and 2242 with key M or key B+M based on PCIe
- Maximum height of the components on the module: 1.5 mm  
application of double-sided assembled modules supported
- Supports NVM Express (NVMe)
- Bootable, from UEFI version 2.3.1
- OS independent, no driver installation necessary

## System requirements

- PC with one free PCI Express x4 / x8 / x16 / x32 slot

## Package content

- PCI Express card
- Low profile bracket
- 1 x fixing screw
- User manual

## Images

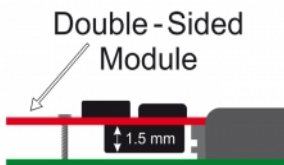
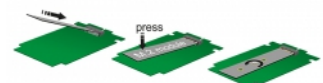
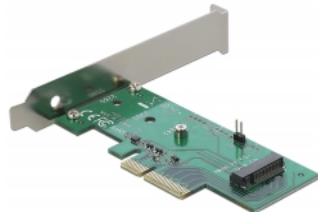

- Internal:
- 1 x M.2 pin M.2 Key M slot
  - 1 x PCI Express v4, V5.0
  - 1 x LED pin header
  - 1 x screw

