

Delock WLAN 802.11 ac/a/h/b/g/n cu antenă I-PEX Inc., MHF® I tată, 1,6 dBi, 11,6 cm, PIFA, intern

Descriere scurta

Această antenă de la Delock permite utilizarea benzilor WLAN de 2,4 GHz + 5 GHz în interior.

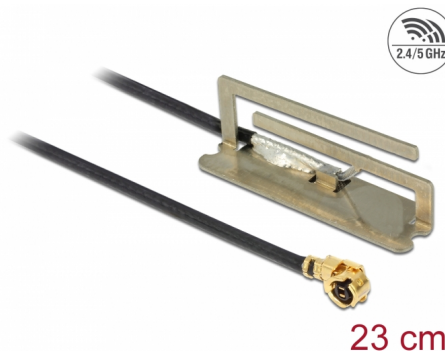

Nr. 86388

EAN: 4043619863884

Țara de origine: Taiwan,
Republic of China

Pachet: Pungă din plastic
cu închidere tip fermoar

Detalii tehnice

- Conector: 1 x I-PEX Inc., MHF® I tată
- Interval frecvență:
2400 MHz - 2500 MHz
5150 MHz - 5875 MHz
- Bluetooth, WLAN 2,4 / 5,0 GHz, ZigBee 2,4 GHz, ISM
- Amplificare antenă: 1,6 dBi
- Impedanță: 50 Ohm
- VSWR: 2,5
- Temperatură în stare de funcționare: -10 °C ~ 55 °C
- Tip cablu: coaxial
- Tip cablu: 1.13
- Culoare cablu: negru
- Diametru cablu: ca. 1,13 mm
- Atenuare cablu: 3,2 dB @ 2,4 GHz pe metru
- Raza minimă de îndoire: 4,5 mm
- Dimensiunii (LxIxÎ): aprox. 21,5 x 7,0 x 6,0 mm
- Lungimea incl. conectori (L): aprox. 23 cm

Cerinte de sistem

- Dispozitiv cu un portsau I-PEX Inc., MHF® I liber

Pachetul contine

- Antenă

Imagini

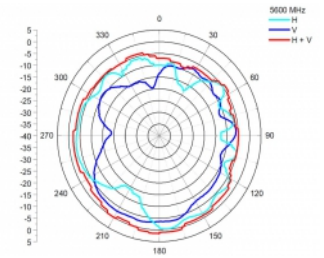
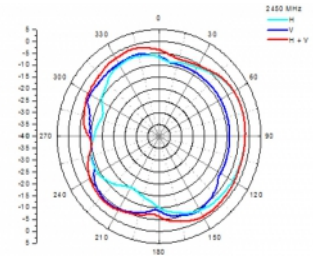
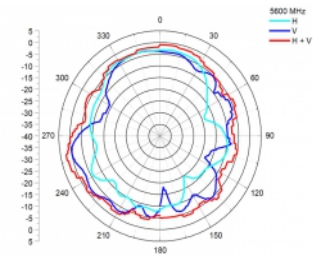
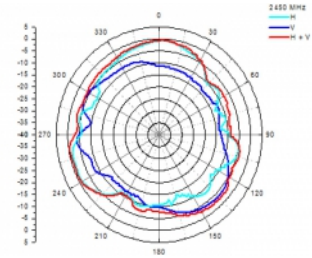
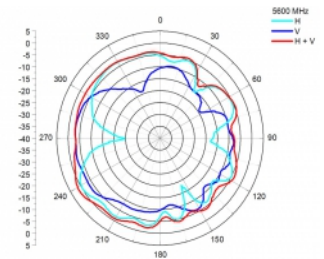
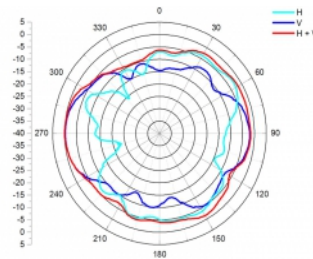
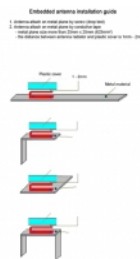
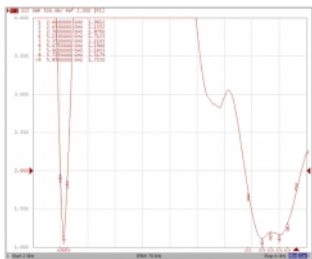

General

Suitable for indoor:	Da
----------------------	----

Interface

connector:	1 x I-PEX Inc., MHF® I tată
------------	-----------------------------

Technical characteristics

Frequency range:	5150 MHz - 5875 MHz 2400 MHz - 2500 MHz
Antenna gain:	1,6 dBi
Impedance:	50 Ω
Temperatură în stare de funcționare:	-10 °C ~ 55 °C
VSWR:	2,0

Physical characteristics

Cable category:	coaxial
Cable type:	1.13
Cable attenuation:	3.2 dB @ 2.4 GHz per meter
Cable colour:	negru
Cable length incl. connector:	23 cm
Lungime:	21,5 mm
Width:	6 mm
Height:	7 mm
Smallest bending radius:	4,5 mm