

# Delock M.2 Key M to 1 x OCuLink SFF-8612 Converter

## Description

This converter by Delock expands the system by one **SFF-8612** interface. It can be connected e.g. one SSD by using an optional cable. The converter transmits PCI Express signals using the NVMe protocol.

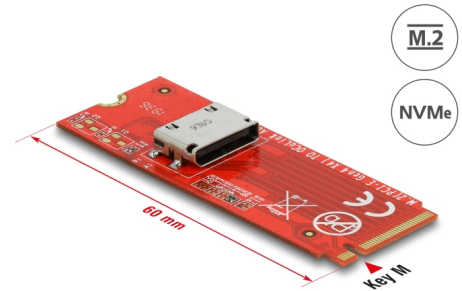

**Item no. 64106**

EAN: 4043619641062

Country of origin: China

Package: Box

## Technical details

- Connectors:
  - 1 x 67 pin M.2 Key M male
  - 1 x OCuLink SFF-8612 female
- Interface: PCIe x4 Rev. 4.0
- Form factor: M.2 2260
- Suitable for M.2 slot with key M based on PCIe
- Data transfer rate up to 64 Gbps
- Bootable, ex UEFI version 2.3.1
- Supports NVM Express (NVMe)

## System requirements

- Linux Kernel 4.6.4 or above
- Windows 8.1/8.1-64/10/10-64/11
- A free M.2 interface with key M

## Package content

- Converter M.2 to SFF-8612
- User manual

## Images

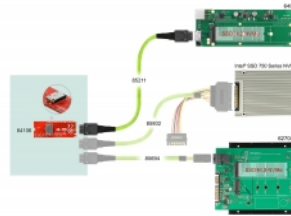

## General

Form factor:	M.2 2260
Function:	NVM Express (NVMe)
Supported operating system:	Linux Kernel 4.6.4 or above Windows 10 32-Bit Windows 10 64-Bit Windows 8.1 32-Bit Windows 8.1 64-Bit
Slot:	PCIe

## Interface

Connector 1:	1 x 67 pin M.2 Key M male
Connector 2:	1 x OCUlink SFF-8612 female

## Technical characteristics

Data transfer rate:	up to 64 Gbps
---------------------	---------------