

Delock M.2 Docking Station for M.2 NVMe PCIe SSD with USB Type-C™ female

Description

This M.2 docking station by Delock enables the installation of an **M.2 PCIe NVMe SSD** and it can be connected via USB to the PC or laptop. The included USB cables allow the connection to a free USB Type-A or USB-C™ port.

Ideal test equipment

The memory is **simply plugged** into the **robust metal housing** and can be used immediately. No screws, tools or accessories are required, which means that the SSD can be changed quickly.

Note

There is no support for SATA M.2 SSD.



Item no. 64000

EAN: 4043619640003

Country of origin: China

Package: Retail Box

Technical details

- Connectors:
 - 1 x SuperSpeed USB 10 Gbps (USB 3.2 Gen 2) USB Type-C™ female
 - 1 x 67 pin M.2 key M slot
- Chipset: Asmedia ASM2362
- Supports M.2 modules with key M or key B+M based on PCIe (NVMe)
- Supports NVMe Express (NVMe)
- Bootable
- Data transfer rate up to 10 Gbps
- LED indicator for power and access
- 1 x On / Off switch
- Metal housing
- Dimensions (LxWxH): ca. 49 x 49 x 12 mm
- Hot Plug, Plug & Play

System requirements

- Chrome OS 78.0 or above

- Linux Kernel 4.3 or above
- Mac OS 10.15.2 or above
- Windows 8.1/8.1-64/10/10-64/11
- PC or laptop with a free USB Type-C™ port or
- PC or laptop with a free USB Type-A port

Package content

- M.2 docking station
- Cable USB-C™ male to USB-C™ male, length ca. 30 cm
- Cable USB-C™ male to USB Type-A male, length ca. 30 cm
- User manual

Images

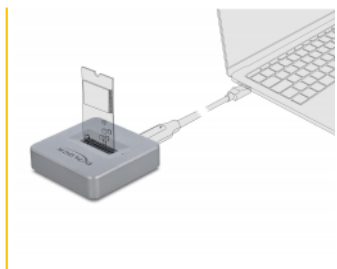

General

Function:	Plug & Play bootable
Supported operating system:	Chrome OS 78.0 or above Linux Kernel 4.3 or above Mac OS 10.15.2 or above Windows 10 32-Bit Windows 10 64-Bit Windows 8.1 32-Bit Windows 8.1 64-Bit Windows 11
LED indicator:	1 x

Interface

Connector 1:	1 x USB 10 Gbps USB Type-C™ female
Connector 2:	1 x 67 pin M.2 key M slot

Technical characteristics

Chipset:	Asmedia ASM2362
Data transfer rate:	10 Gbps

Physical characteristics

Length:	49 mm
Width:	49 mm
Height:	12 mm
Colour:	silver