

# Delock Cable SATA 6 Gb/s 7 pin receptacle + SATA 15 pin power plug > SATA plug pin 8 power with latchtype 30 cm

## Description

This cable by Delock allows the internal connection of e.g. a SATA DOM memory module with SATA pin 8 power connector to a PC. The power supply is provided by the SATA 15 pin plug.

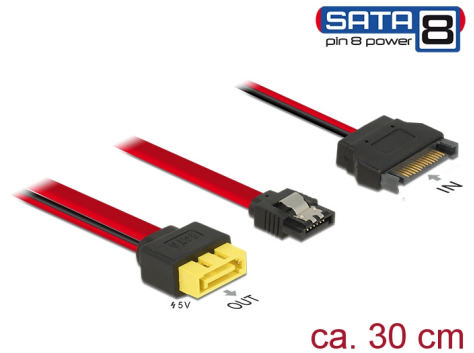

**Item no. 84945**

EAN: 4043619849451

Country of origin: China

Package: Zip poly bag

## Technical details

- Connectors:
  - 1 x SATA 6 Gb/s 7 pin receptacle + 1 x SATA 15 pin power plug >
  - 1 x SATA 6 Gb/s plug pin 8 power with latchtype
- E.g. for SATA DOM memories (e.g. for [Delock item 54776](#))
- Data transfer rate up to 6 Gb/s
- Downwards compatible to SATA 1.5 Gb/s and 3 Gb/s
- Voltage: 5 V
- Cable gauge:
  - 26 AWG data line
  - 18 AWG power line
- Cable diameter: ca. 2.2 mm
- Length without connectors: ca. 30 cm

## System requirements

- Power supply with a free SATA power connector
- A free SATA 7 pin plug on the motherboard

## Package content

- SATA cable

---

## Images

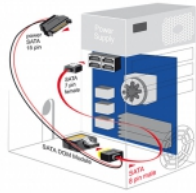

## General

Specification:	SATA 6 Gb/s
----------------	-------------

## Interface

Connector 1:	1 x SATA 15 pin plug 1 x SATA 6 Gb/s 7 pin receptacle
Connector 2:	1 x SATA 6 Gb/s 8 pin plug

## Technical characteristics

Data transfer rate:	6 Gb/s
Voltage:	5 V

## Physical characteristics

Conductor gauge:	26 AWG data line 18 AWG power line
------------------	---------------------------------------