

# Delock Converter SFF-8654 to 1 x M.2 Key M slot

## Description

This Delock converter enables the connection of a M.2 SSD in 22110, 2280, 2260, 2242 and 2230 format. It allows the use of NVMe (PCIe) M.2 SSD. The converter can be installed into the system through an optional cable.

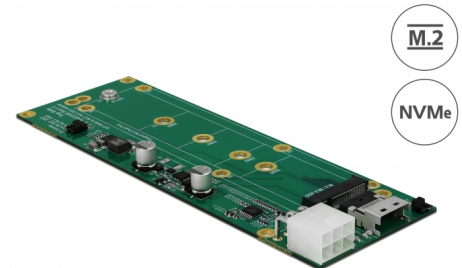

### Item no. 64052

EAN: 4043619640522

Country of origin: Taiwan,  
Republic of China

Package: Box

## Technical details

- Connectors:
  - 1 x 38 pin SFF-8654 4i female
  - 1 x 6 pin power connector
  - 1 x 67 pin M.2 key M slot
- Interface: PCIe
- Supports M.2 modules in format 22110, 2280, 2260, 2242 and 2230 with key M or key B+M based on PCIe
- Maximum height of the components on the module: 1.5 mm, application of double-sided assembled modules supported
- LEDs for power and activity
- Bootable
- Supports NVM Express (NVMe)
- Dimensions (LxWxH): ca. 146 x 50 x 14 mm

## System requirements

- Linux Kernel 4.3 or above
- Windows 7/7-64/8.1/8.1-64/10/10-64

- Connection cables

---

## Package content

- Converter
- 1 x heat sink
- 1 x thermal pad
- Mounting material
- User manual

---

## Images

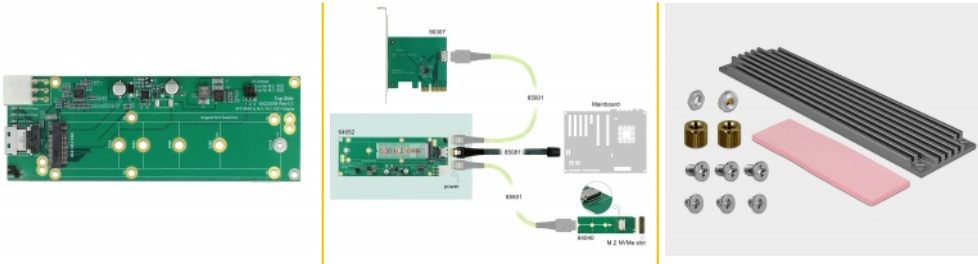

## General

Function:	Bootable, ex UEFI 2.3.1
Supported operating system:	Linux Kernel 4.3 or above Windows 10 32-Bit Windows 10 64-Bit Windows 7 32-Bit Windows 7 64-Bit Windows 8.1 32-Bit Windows 8.1 64-Bit
Slot:	PCIe
Maximum height of the components on the module:	1.5 mm application of double-sided assembled modules supported

## Interface

Connector 1:	1 x 38 pin SFF-8654 4i female
Connector 2:	1 x OCuLink SFF-8612 female
connector 3:	1 x 6 pin power connector