

Delock Converter SFF-8612 to 1 x M.2 Key M slot

Description

This Delock converter enables the connection of a M.2 SSD in 22110, 2280, 2260, 2242 and 2230 format. It allows the use of NVMe (PCIe) M.2 SSD. The converter can be installed into the system through an optional OCuLink cable.

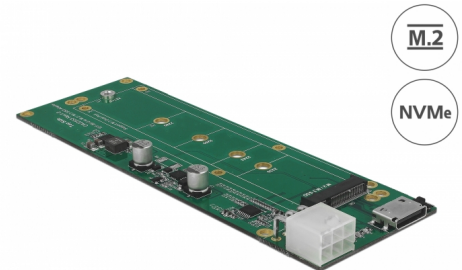

Item no. 64041

EAN: 4043619640416

Country of origin: Taiwan,
Republic of China

Package: Box

Technical details

- Connectors:
 - 1 x OCuLink SFF-8612 female
 - 1 x 6 pin power connector
 - 1 x 67 pin M.2 key M slot
- Interface: PCIe
- Supports M.2 modules in format 22110, 2280, 2260, 2242 and 2230 with key M or key B+M based on PCIe
- Maximum height of the components on the module: 1.5 mm, application of double-sided assembled modules supported
- LEDs for power and activity
- Bootable
- Supports NVM Express (NVMe)
- Dimensions (LxWxH): ca. 146 x 50 x 14 mm

System requirements

- Linux Kernel 4.3 or above
- Windows 7/7-64/8.1/8.1-64/10/10-64

- Connection cables

Package content

- Converter
- 1 x heat sink
- 1 x thermal pad
- Mounting material
- User manual

Images

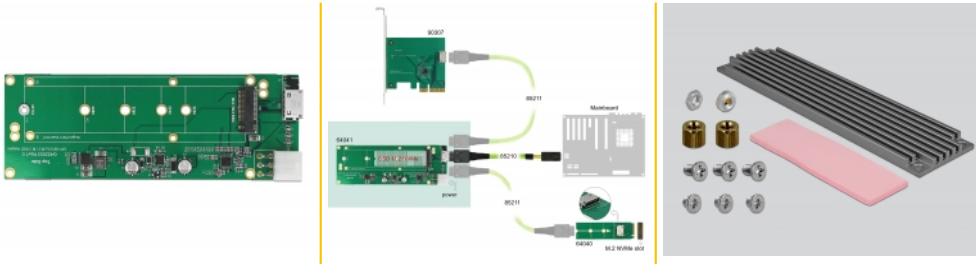

General

Function:	Bootable, ex UEFI 2.3.1
Supported operating system:	Linux Kernel 4.3 or above Windows 10 32-Bit Windows 10 64-Bit Windows 7 32-Bit Windows 7 64-Bit Windows 8.1 32-Bit Windows 8.1 64-Bit
Slot:	PCIe
Maximum height of the components on the module:	1.5 mm application of double-sided assembled modules supported

Interface

Connector 1:	1 x 67 pin M.2 key M slot
Connector 2:	1 x OCuLink SFF-8612 female
connector 3:	1 x 6 pin power connector